



Welcome to the issue 8 of the Greenscene newsletter. In this edition we will be looking at our newest contracts, some new products and some very interesting information on early glasshouses.



***New Products at Greenscene***

*The Lechuza Delta is a new planter style that combines natural shape with elegance. Attractive in its design and convincing in its functionality, the new Lechuza Delta planter was just made for stylish arrangements and exquisite plantings.*

*The New Delta 15 table planter with a height of 10.2 in is a product that can easily be called an "evergreen" based on its appearance alone.*

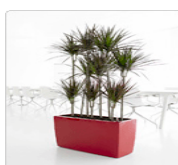

*The Lechuza Cararo combines the classic trough form with Lechuza's characteristic elegance. This makes it the perfect planter for everyone who would like to partition a room or set boundaries to an area without placing boundaries on their own creativity.*

**Greenscenes Newest Contracts**

**FAS New Head Quarters / Training Centre**

This is a large mixed planting scheme comprising of 4.No 5 metre Ficus trees planted in 1 metre cube GRP planters with built in self watering systems in the atrium area. There is a restaurant where Greenscene have used a white tall tapered circular planter 117cm high planted with branched Dracaenas. These have received a great deal of complimentary remarks. In the general office and common areas a new planter called 'trinity square' were used. They are a slightly fluted planter and something different from the traditional straight sided square planter. Zintec silver steel planters with Buxus were used on the terrace areas.

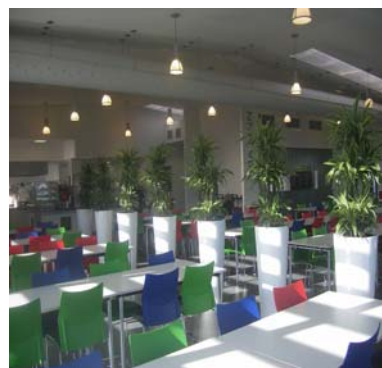

**Zenith Technologies**

A modern planting scheme using quadro (square) black planters to compliment the colour scheme, together with cubico (tall slender planters) to add height to the open plan office area.

**Harvest Financial Services**

This is an interesting oval shaped office space. Following consultation with the client it was decided to use a silver coloured planter throughout the various office areas and the tall slim tapered square planter was the preferred option. The planting included Kentia Palms, Dracaenas in variety, Zamioculcas and Aspidistra where the natural light levels were low.



**Atrium Building – Sandyford Industrial Estate**

Another prestigious contract awarded to the Greenscene team. There was a requirement for eight five metre trees to be planted in leather bound square planters. The building has very high natural light levels so the choice of plant material was wide and varied. After much consideration it was decided to run with eight matching Ficus Ali Amstel King. These trees were acclimatised in Europe having originated in Florida. The resulting plantscaping of the atrium is magnificent with the chosen trees

complimenting the richly coloured leather planters.

**Spencer Dock**

Greenscene were approached to formulate ideas to assist with the routing of pedestrian traffic in this prestigious development. The exterior landscaping of the courtyards is very impressive and it was therefore important to source a product which would compliment the existing planting. A hardwood timber Versailles planter was chosen as the preferred option, planted with Dutch grown quality pyramid Bay Trees.



Did you know that back in the early 19th Century, Dublin was home to one of the worlds leading and most celebrated glasshouse and conservatory manufactures?

The firm was owned by the Turner family and it specialized in manufacturing wrought iron conservatories and glasshouses but also manufactured other items such as garden railings and seats. The foundry was located in Ballsbridge, very near to the present day Ballsbridge Motors showrooms. Its most famous owner was Richard Turner (1798—1881) who was responsible for the design and construction of many famous glasshouses, many of which survive down to the present day—a testament to his design and build quality. Turner is mostly known for his use of the “curvilinear” style of iron glasshouse, which he experimented and perfected in the first half of the 19th Century. Turners designs were the most advanced in the world at that time and he was contracted by no less than three botanical gardens to build glasshouses for them. He was responsible for building most of the curvilinear range at the Botanic Gardens, Glasnevin, Dublin (1847—1848), the wings of the Palm House in Belfast's Botanic Gardens (1839-1840) but his most famous structure is the Palm House he built for the world famous Kew Gardens (1844-1848). Both the Botanic Gardens in Glasnevin and Belfast Botanic Gardens are open to the public free of charge and an ideal place to spend a rainy afternoon wondering around the glasshouse looking at the wonderful array of exotic plants and flowers.



Is your entrance in need of that little bit extra? Here at Greenscene we have the perfect solution Laurus Nobilis (Bay Tree) or the Buxus Sempervirens are perfect for punctuating a formal planting scheme or used in pairs for flanking a set of steps or a doorway. Available in a variety of shapes and sizes these plants are so versatile. You can get so many different looks depending on the planter you decide you use.



As the evenings are getting longer and the sun is shining a little more we can look forward to Greenscenes annually barbeque held at the Nurseries in the weeks to come.

We would like to take this opportunity to welcome the newest member of the Greenscene team Paula Curran. Paula is working in the office as part of the administration team, she is always at the other end of the phone to answer your queries.

### Where the names come from...

*Aechmea* Greek—'a point'. The bracts in the flower head are spear-like

*Aglaonema* Greek—'bright thread'. The stamens are eye catching

*Calathea* Greek— 'basket'. The plant was used by American Indians for basket making

*Impatiens* Latin—'impatient'. Ripe seed pods burst and eject seeds when touched

*Philodendron* Greek—'tree lover'. An apt name for this climber which attaches itself to trees in its natural habitat

